

AUTOMATIC TYRE CHANGER FOR CAR, SUV AND COMMERCIAL VEHICLE



with rotating pole
and turntable
for wheels up to 24"

AQUILA TWISTER 24" TI 2V
+
Helper SRM MINI certified

AQUILA TWISTER

Is an **automatic** tyre changer featuring a pole working with **side rotation**. The innovation of this pole, with **pneumatic rotation**, is that it ensures reduced operating dimensions and allows installing the machine against a wall. This solution allows saving almost 1 m / 3.3 ft and is particularly suitable for places with little space and/or special operating needs.



Automatic version available.
horizontal arm and tool head
vertical arm pneumatic locking.
guaranteed ease and speed
of use!



GENERAL FEATURES

AQUILA TWISTER can clamp rims up to 24" (from outside) with a maximum wheel diameter of 1035mm / 40.7" and 15" width.

It can be used with car, SUV, commercial vehicle and motorcycle wheels (using proper accessories).

It is a **robust** and **reliable** tyre changer for intensive use. The operating pole rotation makes it **handy** and **quick**.

The position and type of demounting/mounting tool ensure precision and safety in all working steps.

Available with single-speed and double-speed motor with inverter.

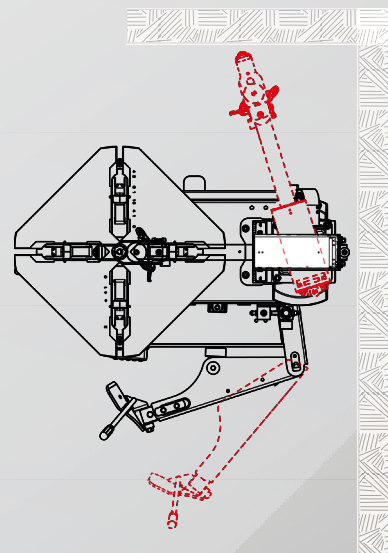

1 | POLE ROTATION

The **operating pole rotation** to the left offers very reduced overall dimensions of the tyre changer.

A benefit of this solution is that the machine can be **positioned against a wall**, thus saving space in the work area and where the space is limited.

Its operation is **quick and handy**, thanks to **pneumatic rotation** and **front positioning** of the demounting/mounting tool.

2 | TOOL HEAD

The demounting and mounting tool is a major innovation for this tyre changer.

The addition of the **newly-designed read tab** offers significant support during mounting step, facilitates tyre installation on the rim and avoids possible damage to the tyre. Plastic protections are also present to avoid scratching the rims.

Very effective also on RFT, UHP e BSR tyres in combination with the bead pressing tool, available as accessory.



3 | TECHNICAL SOLUTIONS

The bead breaking arm features technical solutions that allow easy operation on wheels up to 15" in width.

Technical solutions that, thanks to quick setup, ensure correct positioning of the bead breaking shoe with respect to the wheel, avoiding damage to the tyre and/or rim. Operation is ensured on any type of wheel.

Another important innovation is the introduction of an **adjustment for the inclination of the bead breaking arm**.

This adjustment acts in two different directions: up-down and inside-outside. Thanks to these adjustments, the bead breaking arm will always be in the best possible position.



4 | TURNTABLE

The turntable of **AQUILA TWISTER** is designed to offer high performance and compact size. The mechanism that allows working on wheels from 10" to 24" is patented. The device that changes the working range from 10" – 20" to 14" – 26" (external clamping) is easy to operate.

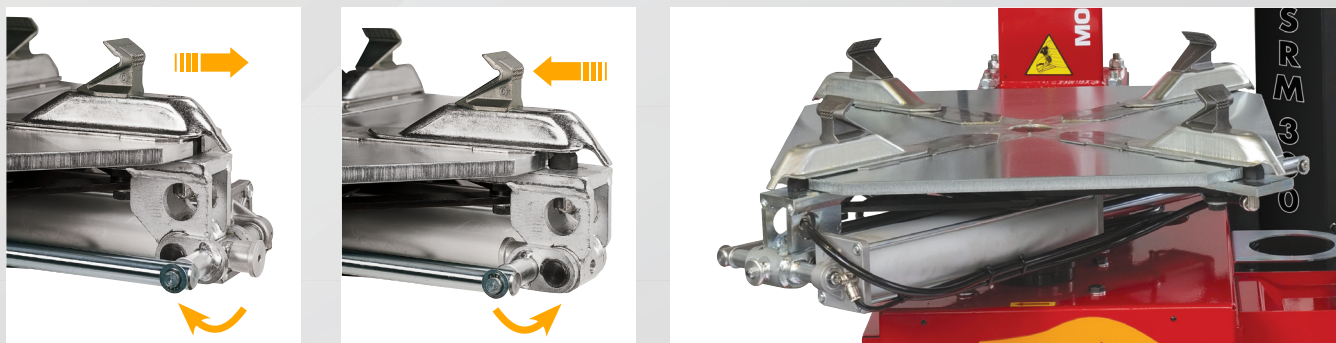

TECHNICAL DATA

outside clamping capacity	10" - 24"
inside clamping capacity	13" - 26"
max. wheel diameter	1.035 mm
height above the ground	690 mm
max. wheel width	385 mm / 15"
bead-breaking blade opening	3" / 15" (385 mm)
max. self centering torque	1.200 Nm / 1.300 Nm by inverter
number of bead breaker blade positions	2
double acting braking cylinder	√
bead breaking force on tire	15,5kN
dv version rotation speed	6-15 Rpm
motoinverter	√
extractable pedal assembly	√
weight without packaging	285 kg - 290 Kg (12V)
version for mobile service	√
pressure range	8 - 10 bar
versions	400/3/50 200/230V - 1Ph - 50/60Hz MI - 2Vel 200/230V - 1Ph - 50/60Hz 12V

DIMENSIONS

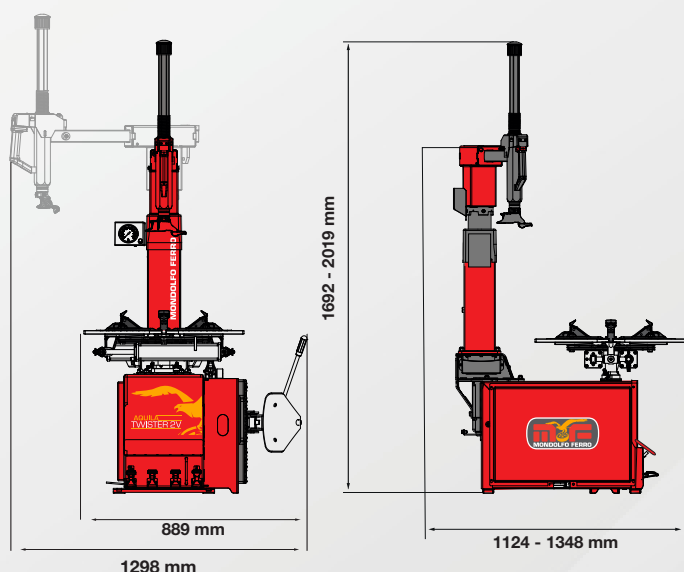

EQUIPMENT



ACCESSORI



- A. 8-11100343**
Bead pressing device SRM
 - B. 801262417**
RFT -WDK bead pressing pliers
 - C. 80143685**
Bead pressing pliers
 - D. 8-11100451**
Multipurpose device for tyre changers
- For more information, please consult the accessories catalogue.